

MATRIKS INTEGRATION GUIDE

What is Matriks?

Matriks Connector enables Claude to access real-time and historical Turkish and global market data directly within conversations. Users can retrieve stock prices, financial statements, technical analysis, broker flows, news, and more all through natural language, without switching between platforms.

Real-Time Market Data Instant prices for BIST stocks, indices,	Fundamental Analysis Balance sheet, income, cash flow, ratios, dividends	Technical Analysis Pivot levels, RSI, MACD, candlestick patterns
Institutional Flows Broker buy/sell activity, foreign investor data, market makers	News & Events KAP announcements, market news, economic calendar	Fund & Derivatives Mutual funds, ETFs, options, futures, warrants

Table 1: Key Capabilities

Prerequisites

Before connecting Matriks to Claude, you need:

- A Matriks account.
- A Matriks MCP API Key — generated from the MCP portal at mcp.matriks.ai
- Claude Desktop or access to Claude.ai (web)

Claude Integration

1. Step: Obtaining an API Key from Matriks MCP Portal

To use the Matriks MCP service, you first need to generate an API Key. Log in to the Matriks MCP Portal and navigate to the API Keys section in the left menu. Click the New API Key button to create a new key for your account. This key will be used for authentication in Claude and other AI integrations.

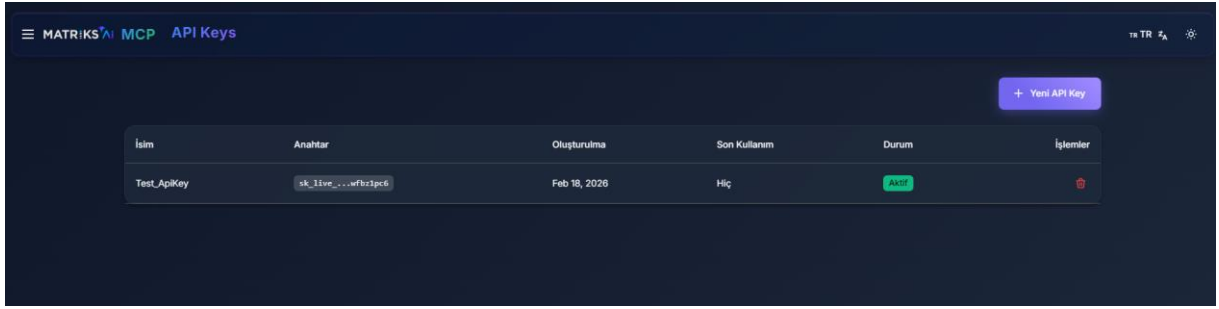

Figure 1: Matriks MCP Portal — API Keys screen with the New API Key button

To use the Matriks MCP service, you first need to generate an API Key. Log in to the Matriks MCP Portal and navigate to the API Keys section in the left menu. Click the New API Key button to create a new key for your account. This key will be used for authentication in Claude and other AI integrations.

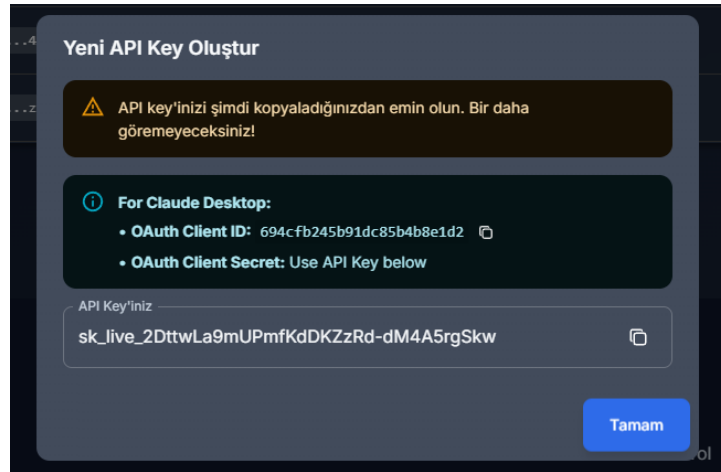

Figure 2: Sample OAuth credentials — Client ID and Client Secret values

The following are sample integration credentials for reference only. Replace these values with your own account credentials in your actual integration:

OAuth Client ID: 694cfb245b91dc85b4b8e1d2

OAuth Client Secret: sk_live_2DttwLa9mUPmfKdDKZzRd-dM4A5rgSkw

2. Step: Claude Desktop Integration

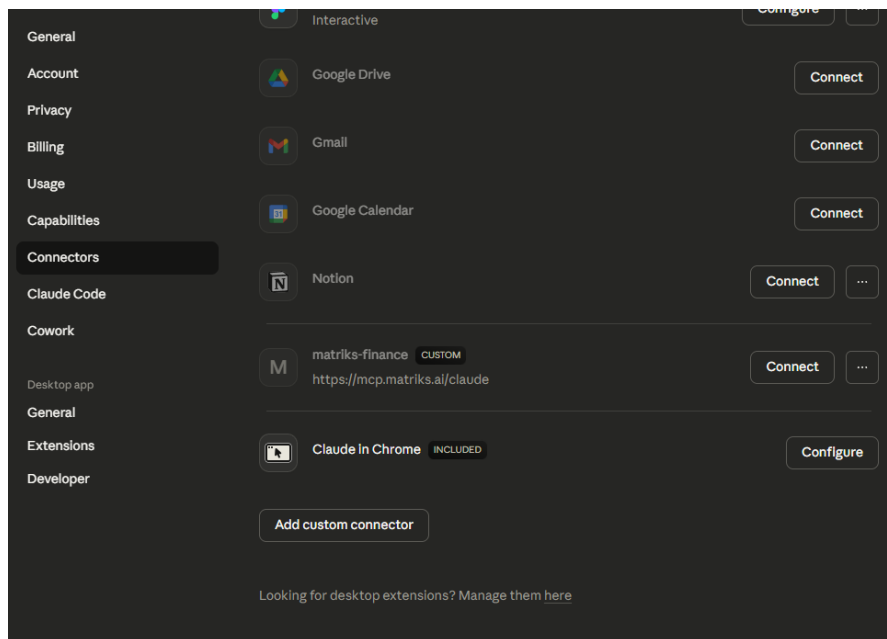

Figure 3: Claude Desktop — Connectors menu and the Add custom connector option.

After obtaining your API Key, open the Claude Desktop application. Navigate to the Connectors section in the left menu and click Add custom connector. This is the starting point for introducing the Matriks MCP server to Claude.

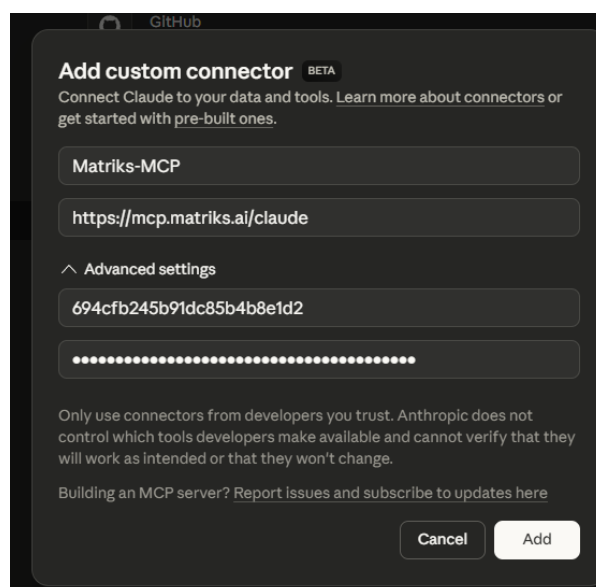

Figure 4: Connector configuration form — name, Remote MCP Server URL, and credentials

In the form that appears, fill in the following fields: enter a descriptive name in the Connector Name field (e.g. "Matriks MCP"), enter `https://mcp.matriks.ai/claude` in the Remote MCP Server URL field, and provide the Client ID and Client Secret obtained in Step 1.

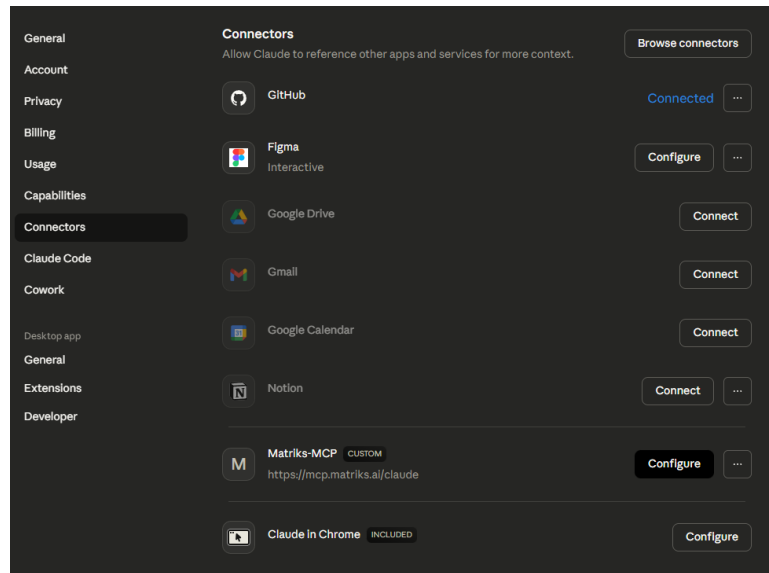

Figure 5: Matriks MCP successfully connected — 'Connected' status in Claude Desktop

Once all fields are completed, click Add to save the connector. Claude will initiate the OAuth authorization flow log in with your Matriks account when prompted to complete the connection. After successful authorization, Matriks MCP will appear as Connected in your Connectors list and will be ready to use in any Claude conversation.

Available Tools (22)

Complete list of tools provided by the Matriks MCP connector.

#	Tool Name	Description
1	marketPrice	Returns real-time price data for BIST stocks, indices, and inflation rates (CPI, PPI).
2	stockProfile	Provides a comprehensive stock profile including price, financial ratios (P/E, P/BV, ROE), and technical indicators.
3	marketOverview	Summarizes top gainers/losers, volume leaders, and sector performance across BIST.
4	foreignMarkets	Returns exchange definitions, symbols, and real-time NBBO data for US and global markets.
5	symbolSearch	Searches and lists stocks, indices, ETFs, warrants, and other instruments by name or code.
6	historicalData	Fetches historical OHLCV price bars, statistics, and benchmark comparisons for a given symbol.
7	fundamentalAnalysis	Analyzes balance sheet, income statement, cash flow, financial ratios, dividends, and capital increases.
8	technicalAnalysis	Provides pivot levels, indicator signals (RSI, MACD, etc.), and peak/trough point analysis.
9	sessionAnalysis	Analyzes BIST trading sessions (opening, intraday, closing) by volume or quantity.
10	performanceAnalysis	Answers peak/trough and period-based performance questions for stocks and indices.
11	riskAnalysis	Provides market risk indicators, short selling pressure analysis, and settlement data.
12	institutionalFlow	Analyzes broker-level buy/sell activity, money flow trends, and foreign investor data.
13	memberTrades	Returns detailed trade logs for a specific brokerage firm on a given day.
14	sectorAnalysis	Provides sector and index weight distribution, performance analysis, and stock correlations.

15	settlementAnalysis	Analyzes MKK clearing and settlement data by broker or symbol.
16	comparison	Compares multiple stocks and benchmarks by return, relative performance, and correlation.
17	newsAndEvents	Fetches KAP announcements, market news, important events, and economic calendar data.
18	brokerResearch	Searches broker research reports, analyst recommendations, and target prices.
19	ipoCalendar	Provides IPO calendar with details on upcoming, ongoing, and completed public offerings.
20	economicCalendar	Lists scheduled economic events and indicators for TR, US, EU, and other countries.
21	fundAnalysis	Provides prices, returns, and portfolio analysis for mutual funds (YF), pension funds (BEF), and ETFs (BYF).
22	derivativeAnalysis	Comprehensive analysis for options, warrants, and futures including pricing, Greeks, and spread analysis.